

EXHIBIT "A"
LEGAL DESCRIPTION AND SKETCH
THIS IS NOT A SURVEY

PAGE 1 OF 2



DESCRIPTION :

ALL THAT PORTION OF THE 15' ALLEYWAY LYING BETWEEN OF LOTS 14, 15, 16, 17, 18 AND 19, BLOCK 17, RIVIERA, ACCORDING TO THE PLAT THEREOF, AS RECORDED IN PLAT BOOK 2, PAGES 90 AND 91, PUBLIC RECORDS OF PALM BEACH COUNTY, FLORIDA.

BEING MORE PARTICULARLY DESCRIBED AS FOLLOWS:

BEGINNING AT THE SOUTHWEST CORNER OF SAID LOT 16, BLOCK 17, BEING ALSO THE SOUTHEAST CORNER OF THE ALLEYWAY; THENCE PROCEED N87°57'56"W A DISTANCE OF 15.00 FEET TO THE SOUTHWEST CORNER OF LOT 17, BLOCK 17; THENCE PROCEED N02°43'59"E ALONG THE WESTERLY LINE OF SAID ALLEYWAY ALSO BEING THE EASTERLY LINE OF LOTS 17, 18, AND 19 OF SAID BLOCK 17, A DISTANCE OF 75.00 FEET; THENCE PROCEED S87°57'56"E A DISTANCE OF 15.00 FEET TO THE NORTHWEST CORNER OF LOT 19, BLOCK 17, ALSO BEING THE EASTERLY LINE OF SAID ALLEYWAY; THENCE PROCEED ALONG SAID EASTERLY LINE, ALSO BEING THE WESTERLY BOUNDARY LINE OF LOTS 17, 18, AND 19, BLOCK 17, S02°43'59"W A DISTANCE OF 75.00 FEET TO THE POINT OF BEGINNING.

CONTAINING 1128.47 SQUARE FEET

SURVEYORS' NOTES:

1. THIS SKETCH OF DESCRIPTION MEETS STANDARDS OF PRACTICE SET FORTH IN RULE 5J-17.050-.052, FLORIDA ADMINISTRATIVE CODE, PURSUANT TO FLORIDA STATUTES.
2. THIS FIRM'S CERTIFICATE OF AUTHORIZATION NUMBER IS LB 8261.
3. THIS SKETCH AND LEGAL DESCRIPTION IS NOT VALID WITHOUT THE SIGNATURE AND RAISED SEAL OF THE SURVEYOR AND MAPPER NAMED HEREON.
4. THIS SKETCH AND LEGAL IS BASED ON A SURVEY PREPARED BY THIS OFFICE.



**PRINCIPAL
MERIDIAN
SURVEYING INC.**

4546 CAMBRIDGE STREET
WEST PALM BEACH, FL 33415
PHONE 833.478.7764 / FAX 561.478.1094
WWW.PMSURVEYING.NET

JOB#S20-0073

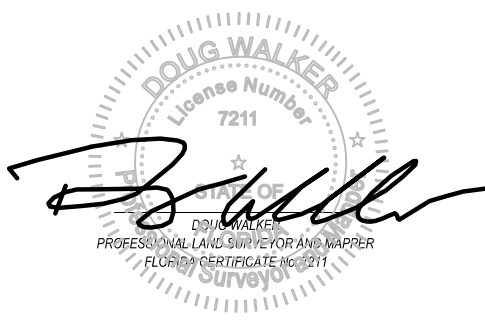

DATE: 12-14-21